

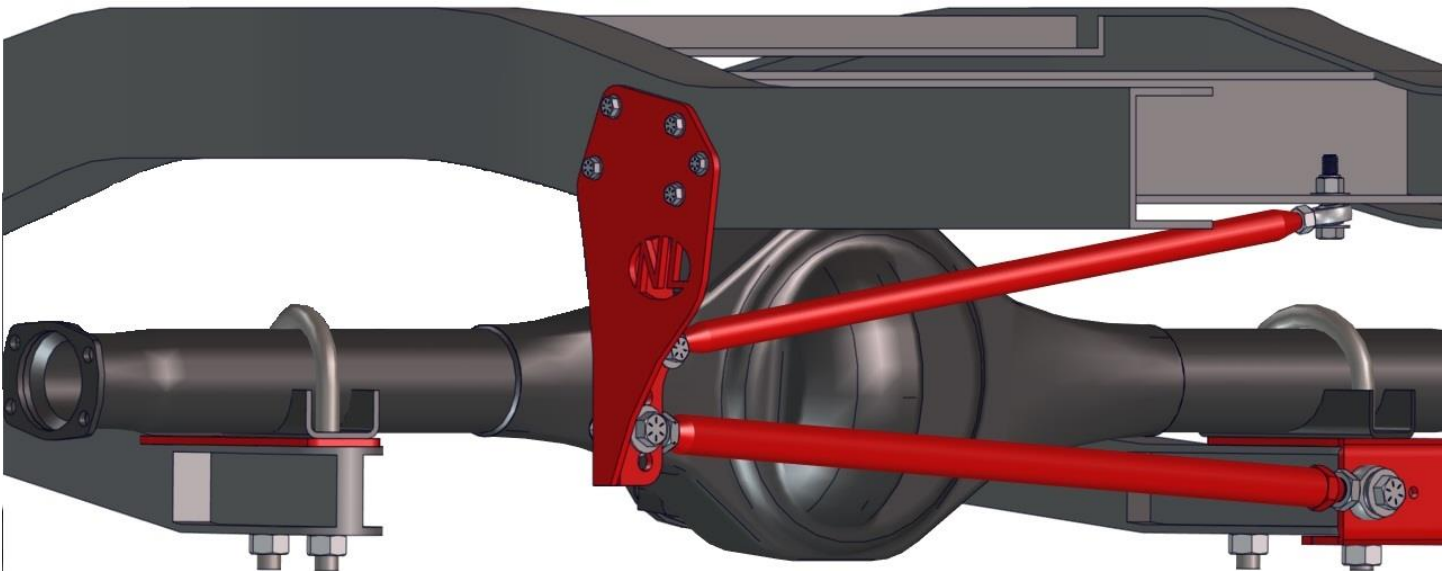

## 1963-72 CHEVY PICK-UP REAR PANHARD KIT



### What's Included:

1	Frame Mounting Bracket	4	3/8"-24 x 1 1/4" Bolts	
1	Frame Mounting Bracket Spacer	4	3/8"-24 Nyloc Nuts	
1	Brace Bar w/ Heim Joints & Nuts	8	3/8" Washers	
1	PanHard Bar w/Left-Right Heim Joints & Nuts	1	5/16"-24 x 1" Bolt	
1	Left Side Trailing Arm Mount	1	5/16"-24 Nyloc Nut	
1	Right Side Trailing Arm Mount	2	5/16" Washers	
2	5/8"-18 x 2 1/4" Bolts	2	1/2"-13 x 2 1/4" Bolts	
2	5/8"-18 Nyloc Nuts	2	1/2"-13 Nyloc Nuts	
2	5/8" Washers	4	1/2" Washers	
2	5/8" Lock Washers			

**Note:** For this installation the bed of the Truck **WILL NOT** have to be removed.

## Step 1:

- In order for ease of removal spray the U-Bolt nuts on the trailing arms with a penetrating lubricant such as **WD-40** or **PB Blaster** and let soak while installing the other parts.

## Step 2:

- Remove the original PanHard Bracket
- Place the Frame Mounting Bracket against the outside of the driver's side Frame Rail (**Note: some frame rails of this era have an existing hole in which the 5/16" hole on the Frame Mounting Bracket should line up with and bolt up to).**

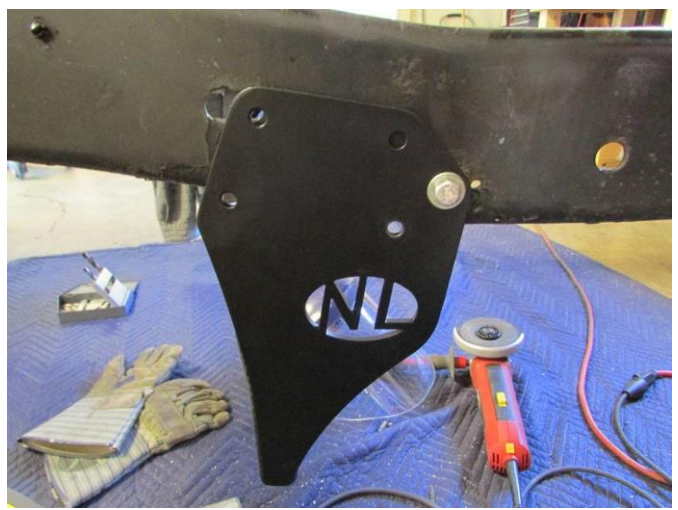

- If your frame rail is missing this hole the Frame Mounting Bracket can be positioned by placing the 5/16" hole at **20 13/16"** from the end of the frame rail, touching the **BOTTOM** of the frame rail with the mounting tabs and lining the top of the Frame Mounting Bracket parallel with the **TOP** of the frame rail.

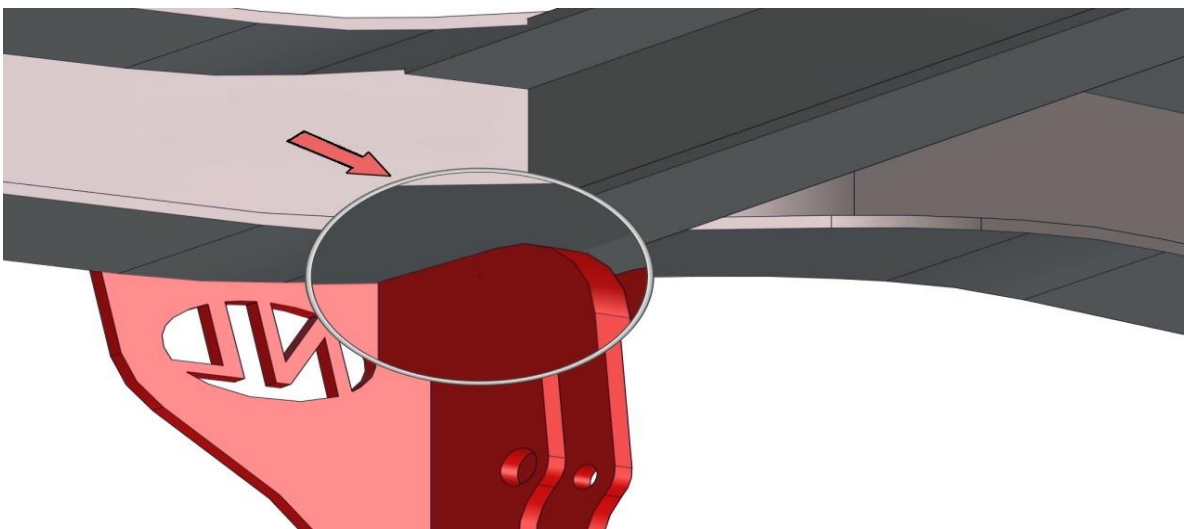

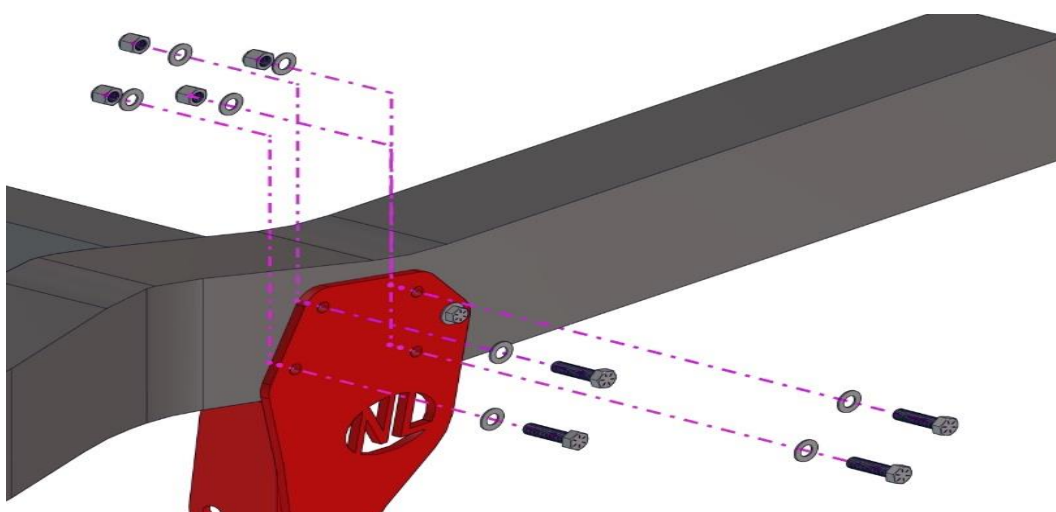
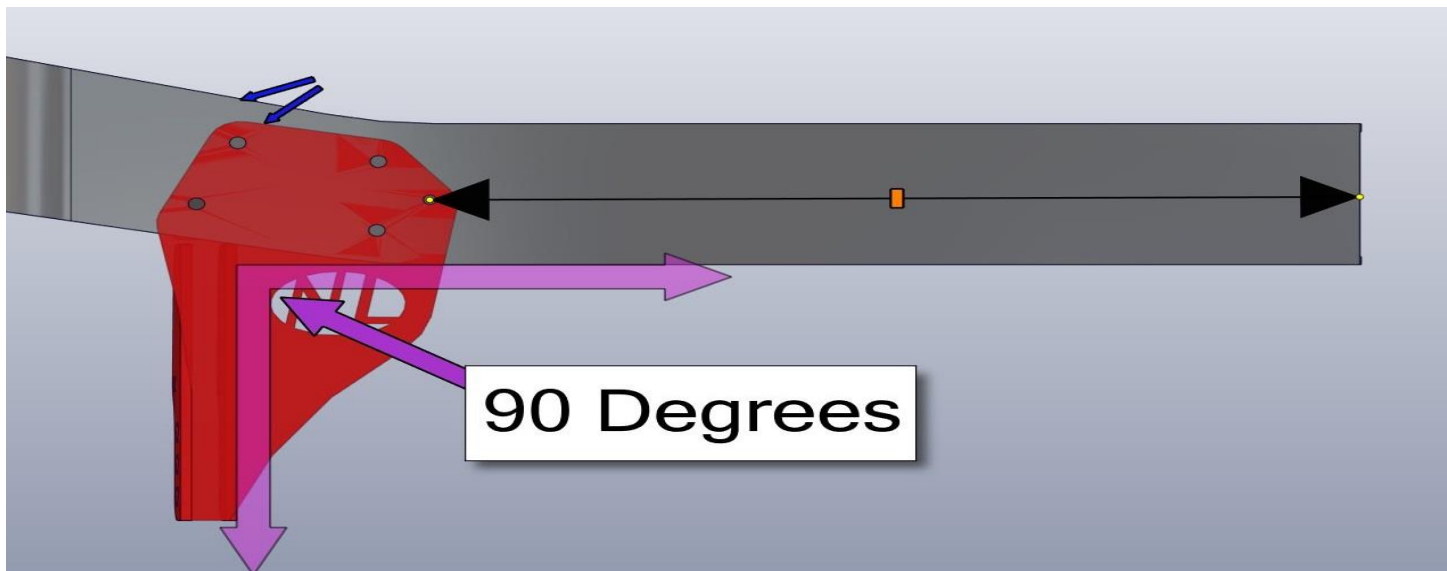

- Clamp the Frame Mounting Bracket to the frame in this position, then mark and drill the 3/8" and 5/16" holes for the provided Hardware. Please torque bolts to **40 lb-ft.**

### Step 3:

- Once the Frame Mounting Bracket is positioned, attach the Brace Bar to the Frame Mounting Bracket

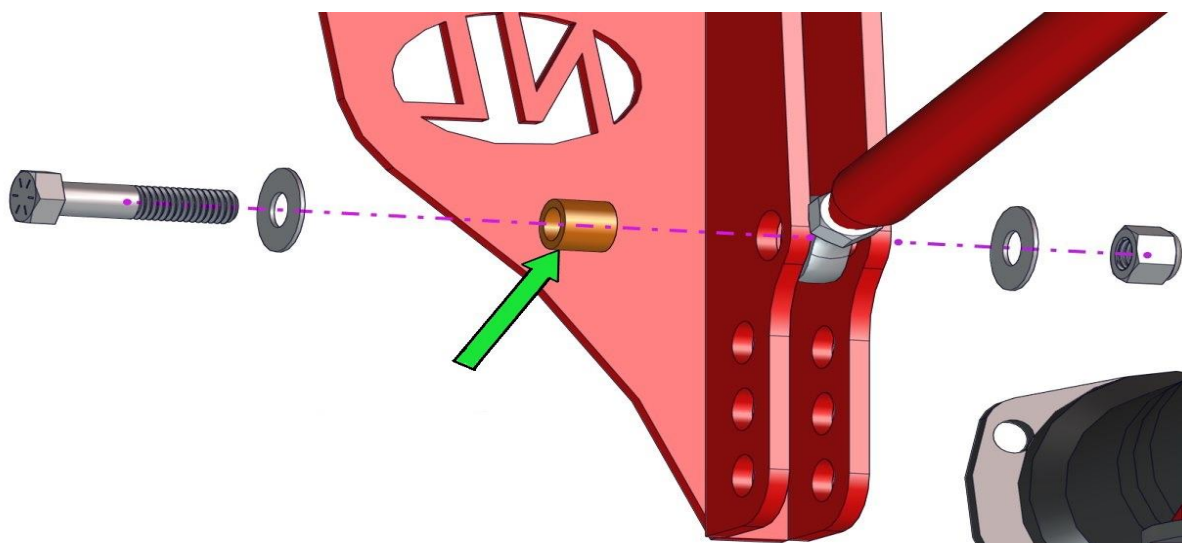

using the Frame Mounting Bracket Spacer and **½"-13** Hardware. Do not tighten the bolt for the next step.

- Rotate the Brace Bar until the heim joint sits against the middle of the crossmember behind the rear axle. Length on this bar is **NOT** critical, and can be installed with the heim joints threaded all the way in. Place the heim joint to the Bottom of the crossmember and mark the center as a  $\frac{1}{2}$ " hole will have to be drilled.

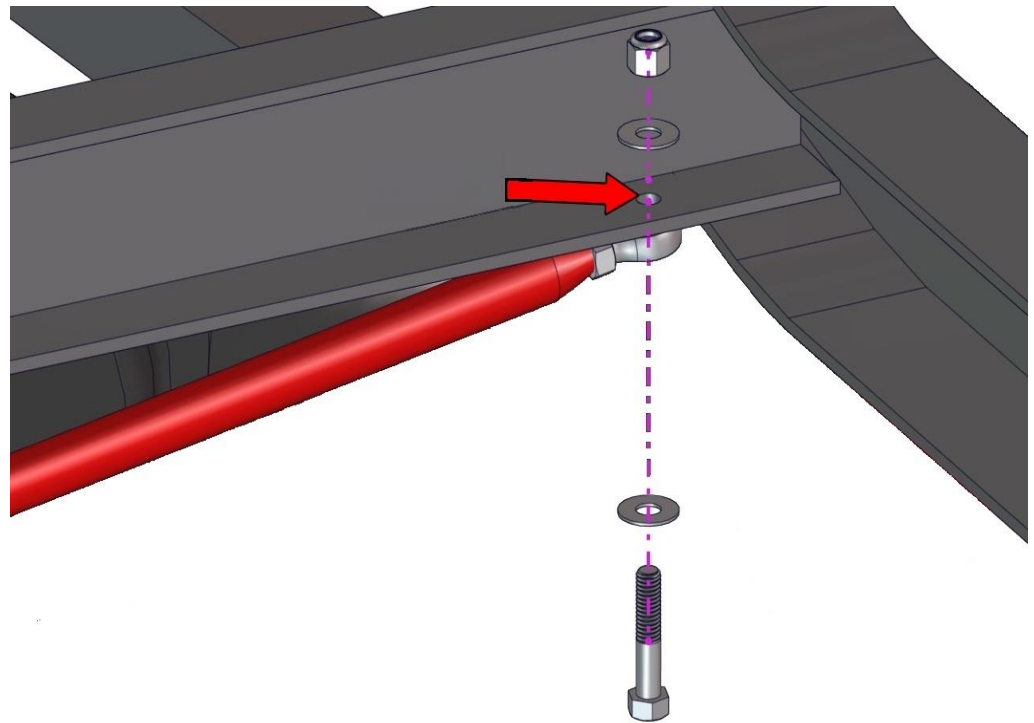

- After the hole is drilled, install the remaining  $\frac{1}{2}$ " hardware and torque the bolts to **75 lb-ft** and tighten each jam nut thoroughly.

## Step 4:

- Having Let the U-Bolts on the trailing arms soak with penetrating fluid, loosen each nut and remove both U-Bolts.

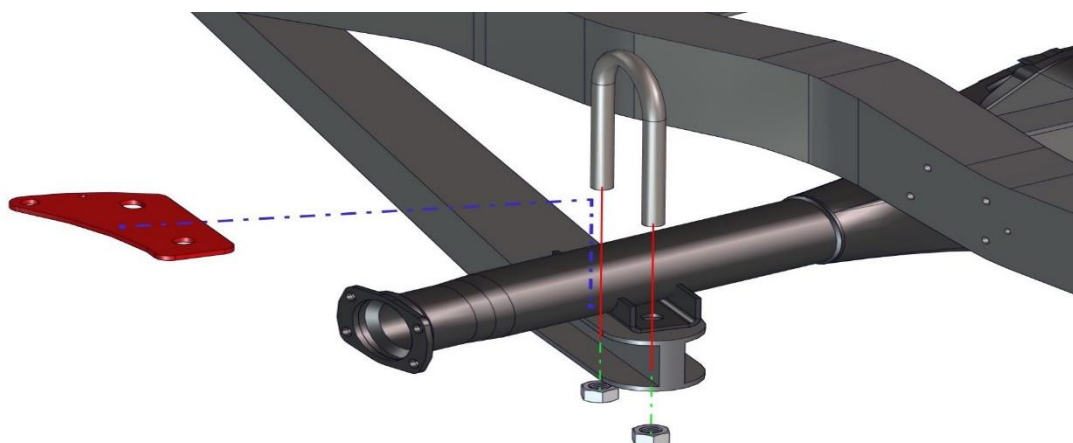
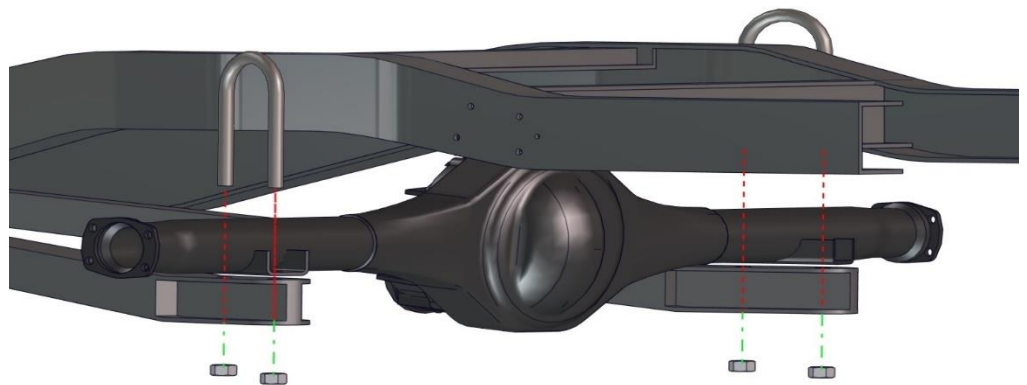

- Slide the Left-Side Trailing Arm Mount between the axle and trailing arm and reinstall the U-Bolt, but **DO NOT** tighten the nuts yet.



- Next, slide the Right-Side Trailing Arm Mount on the right side between the axle and the trailing arm (**Note: The Right-Side Trailing Arm Mount wraps around the rear of the trailing arm and has two holes to line up**). Reinstall the U-Bolts and torque them to **110 lb-ft**.

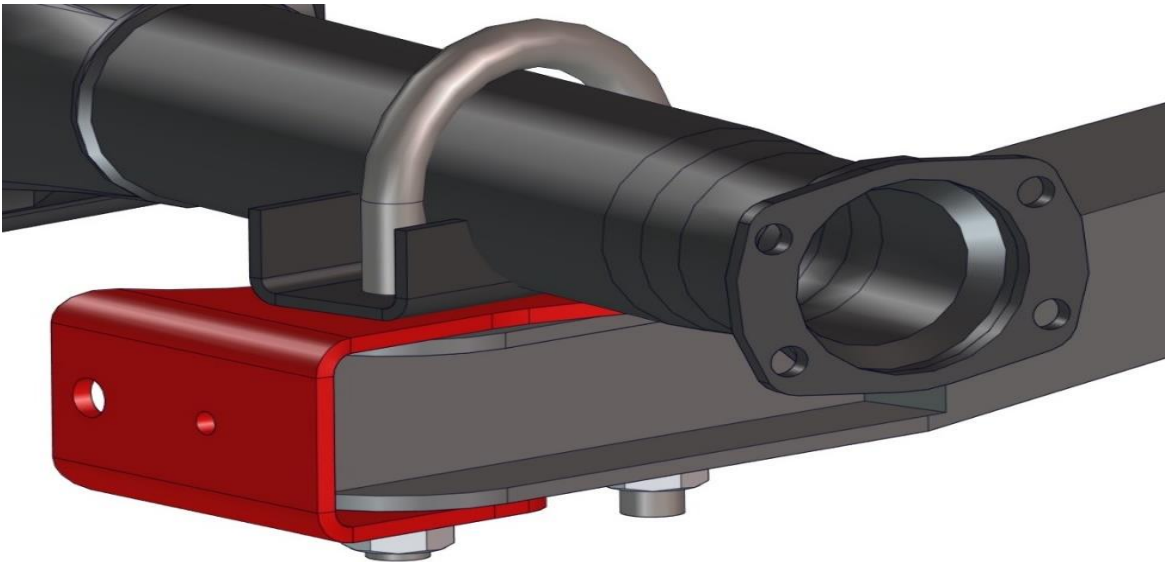
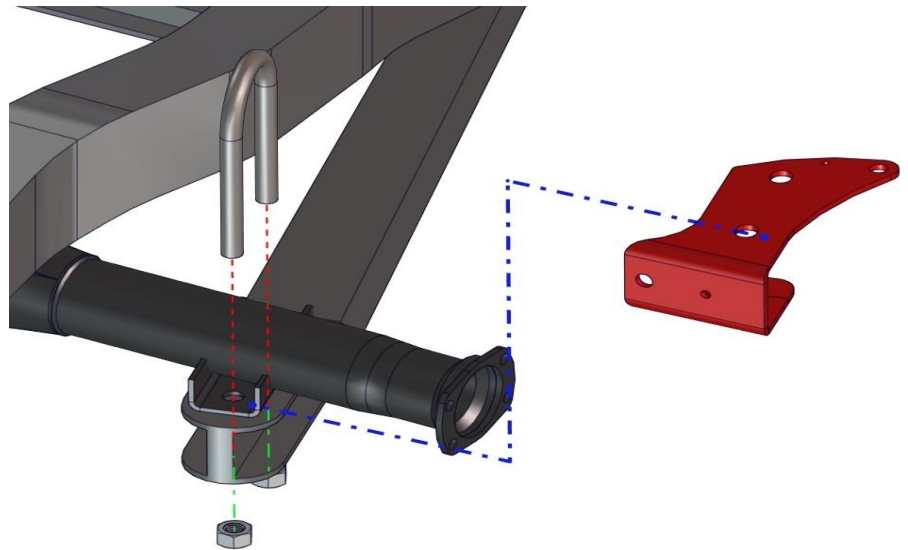

## Step 5:

- Finally, Install the Panhard Bar to the Frame Mounting Bracket and to the Right-Side Trailing Arm Mount using the 5/8" Hardware. (**Note: There is a Right-Hand and Left-Hand threaded heim joints, it DOES NOT matter which side they go to. Keep each heim joint completely loose in order to realign the axle at the end of the install**). Torque each bolt to **125 lb-ft**.

